

DAMPERED SCREW / SPIN on COLLARS

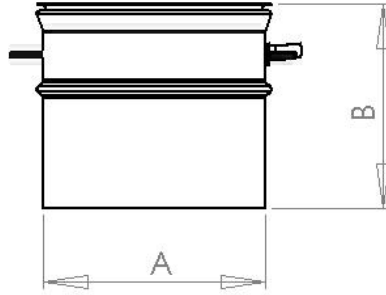

DIAMETER	CODE	A	B
4"	DSC04T	4"	6"
5"	DSC05T	5"	6"
6"	DSC06T	6"	6"
7"	DSC07T	7"	6"
8"	DSC08T	8"	6"
9"	DSC09T	9"	6"
10"	DSC10T	10"	6"
12"	DSC12T	12"	6"
14"	DSC14T	14"	6"

24 gauge.

Galvanized G90 coated.

Fitted with a regulator to adjust the air flow through the duct.

"B" can be customized to required length.